



DATA SHEET

JEMCO



الکتروموتور ۲۰۰ کیلووات ۳۰۰۰ دور ماشینهای الکتریکی جوبین (جمکو)

Subject: Low voltage squirrel cage induction motors

Customer		Manufacturer		Jemco			
Motor Type		YU1315-2AO		Average sound pressure level	No load	load	
Frame Size	315L	Number of poles	2				
Mounting design	IM B3	Type of encloser	IP-55	Direction of rotation both <input type="checkbox"/> CW <input type="checkbox"/> CCW <input type="checkbox"/>			
EX-Protective system	safe	Bearing DE/NDE		6217-c3/6217-c3			
Duty type	S1	Starting	Lubrication Li Base Grease				
Ambient Temperature	40 C		Type of lubrication K3N Din 51825				
Thermal classification	F	Tempertur rise	B	typical Test IEC60034-1			
Term motor protection	optional	outline dimention drawing No.		available			
Retad output	200 KW		Location of Terminal Box		top		
rated voltage	380V		Number of terminals		6		
connection	DELTA		space heater		optional		
Ferquency	50 HZ.	speed	2967 rpm	Net weight approx. 1310Kg			
Rated current	346 A		painting RAL 7032				
Starting Current	(I _s /I _N)		6.8		Termal Protection optional		
Power Factor	4/4	3/4	1/2	Additional Sensor optional			
	0.89			Frame Material cast iron			
Efficiency	4/4	3/4	1/2				
	93.7%						
Rated torque	(T _N)		644 Nm				
starting torque	(T _s /T _N)=		1.8				
Break-down torque	(T _{max} /T _N)=		2				
Rotor class/material	squirrel cage		Aluminium				
Rotor voltage	Rotor current						
Rotor inertia	2.5 Kgm ²						
cooling method	IC411						
altitude of instalation	1000m						
Date		Name		Tolerances acc. To		NO.	
Designed							
checked							

- Additional data and remarks:
- 1- permisslbie percentage Voltage imbalance not greater than 1%
 - 2- Cold Starting per Hour(3)
 - 3- Hot Starting per Hour(2)
 - 4- Maximum Hot starting Time not more than 60 second
 - 5- Maximum cold Time not more than 80 second

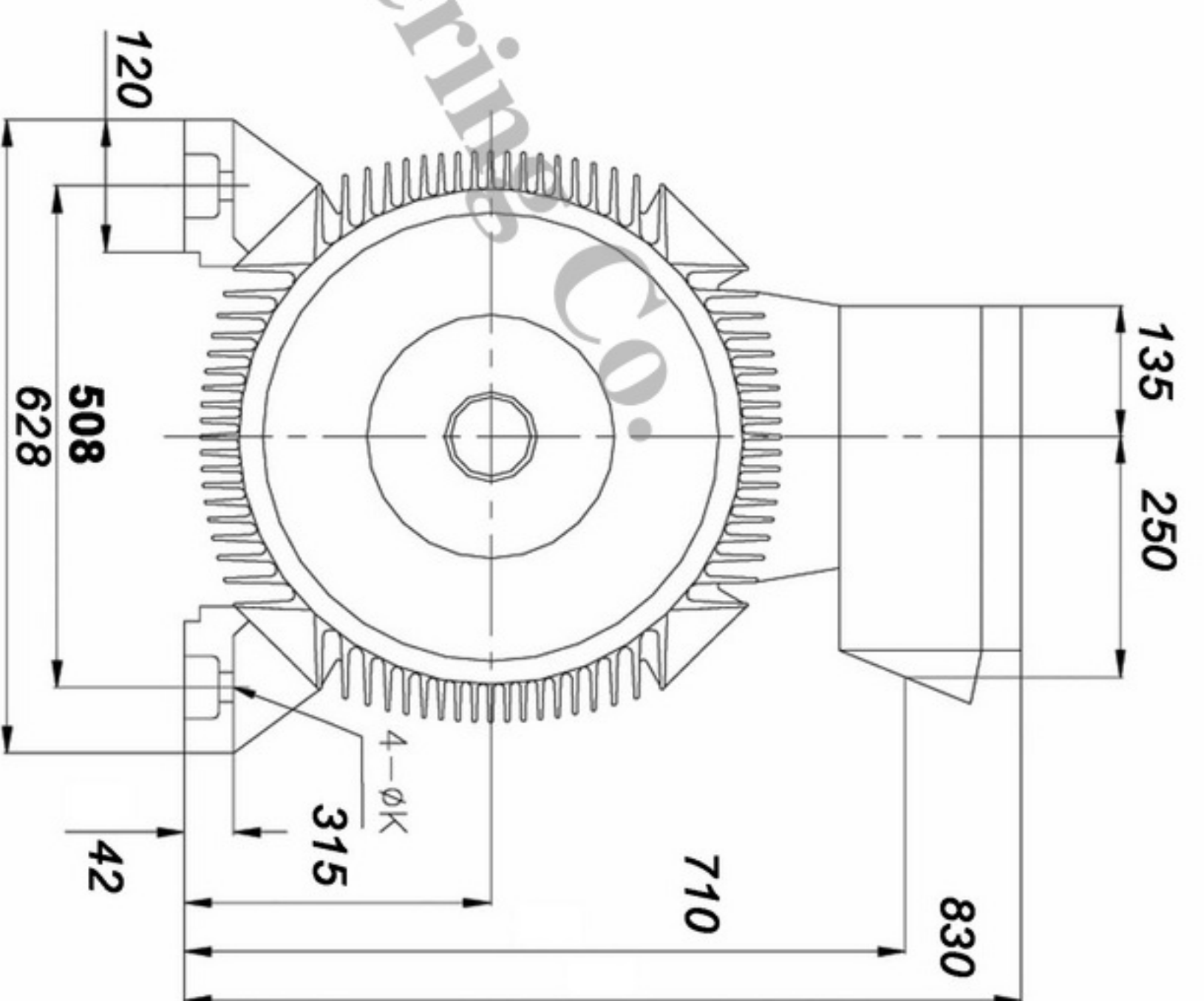
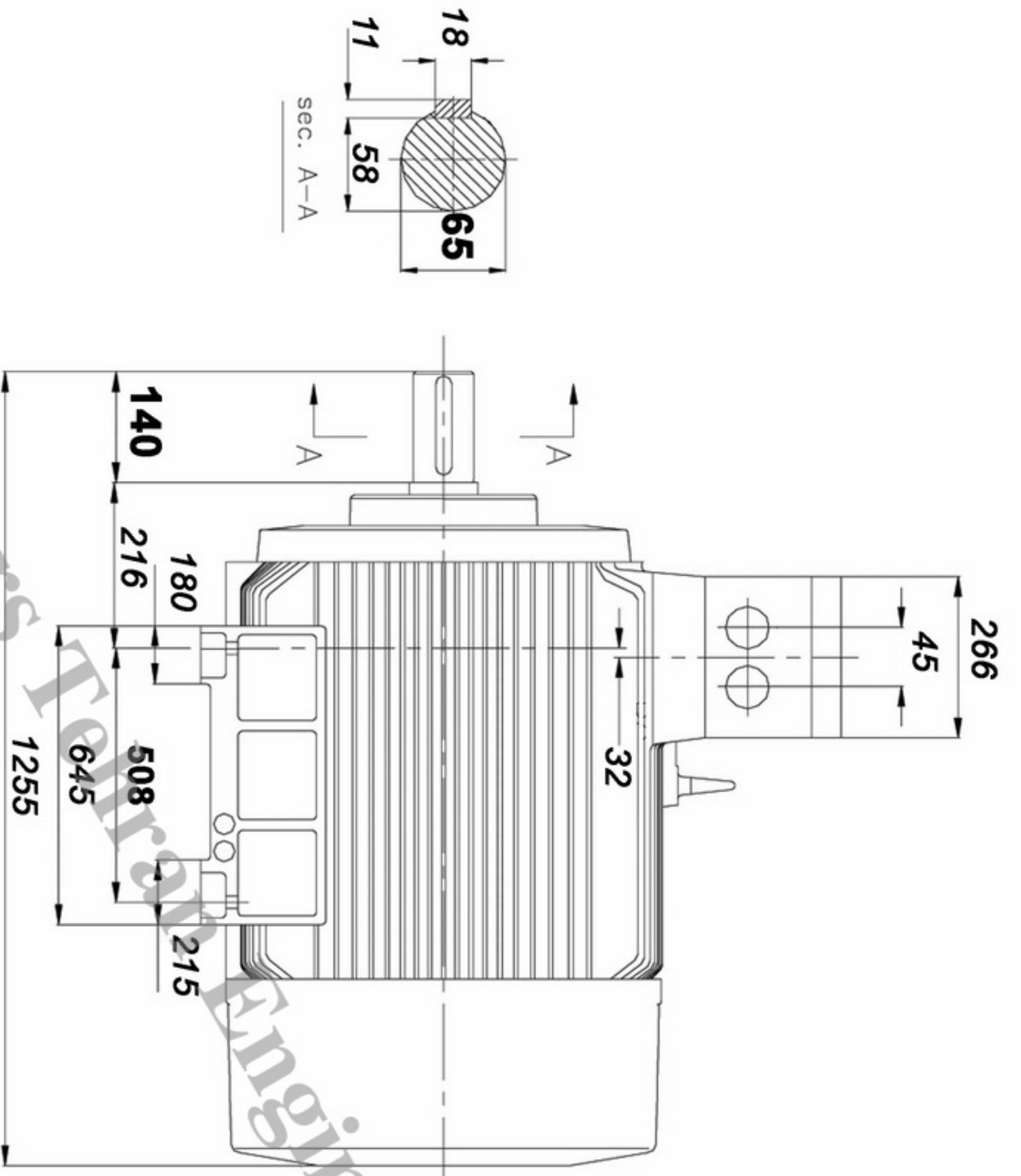

PARS TEHRAN ENG. CO.
PTCO

	Offer No.:
	Project:
Power: 200Kw	
Date:	
Unit: mm	
JEMCO	Code: YU1315-2A0
	Frame: 315L